

UNCONTROLLED

C3518-B REV. D

REVISIONS			
SYM	DESCRIPTION	DATE	APPROV
D	ADD TOL. PER ECN 1085	4-29-08	S.F

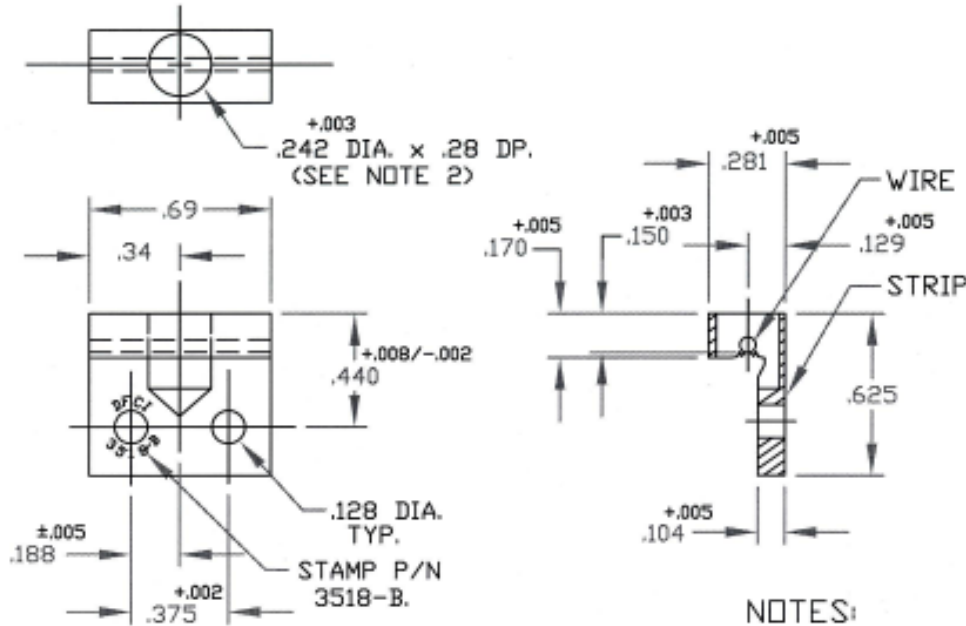

NOTES:

- MATLS: STRIP: 6061-T6 ALUM. ALLOY PER QQ-A-200/8. WIRE: .050 DIA. ST. STEEL TYPE 316, PER ASTM-A-313, SPRING TEMPER.
- SOME DISTORTION MAY ENTER THE .242 DIA. HOLE, DUE TO STAKING OF WIRE. THIS WILL NOT AFFECT THE FUNCTION OF THE PRODUCT.
- FOR RECEPTACLE LENGTHS LONGER THAN .69", WITH MULTIPLE HOLES. REFER TO DRAWING NO. C3590-H.

PART NO.  
3518-B

MATL PER NOTE 1.	TOLERANCES ON DIMENSIONS UNLESS OTHERWISE SPECIFIED X = ±2" .XX = ±.015 X/X = ±1/32 .XXX = ±.010 MACHINE FINISH 125T		<b>DFCI SOLUTIONS INC.</b> 425 UNION BOULEVARD WEST ISLIP, NEW YORK 11795	
HEAT TREAT NONE.	PART NO.	DRN S. F. Francis	DATE 2-20-04	<b>PA-3500 RECEPTACLE LINE, 3518-B.</b>
FINISH CLEAN & FREE OF BURRS.		CHK F. Basile	DATE 5-1-08	
<small>THE FASTENER PARTS SHOWN IN THIS PRINT ARE PROPRIETARY ARTICLES TO WHICH DFCI SOLUTIONS, INC. RETAINS THE EXCLUSIVE RIGHTS OF MANUFACTURE, USE AND SALE. THE PRINT OR DRAWING IS SUBMITTED IN CONFIDENCE AND DOES NOT CONVEY A LICENSE OR PERMISSION TO MANUFACTURE THE PARTS OR FASTENER PARTS.</small> <small>© COPYRIGHT 2005, DFCI SOLUTIONS INC. ALL RIGHTS RESERVED.</small>	NEXT ASSY	USED ON S. Wilder	DATE 5/1/08	SIZE A
	APPLICATION BLOCK	SALES	DATE	FSCM NO 72794
				DWG. NO. C3518-B
				REV. D
				SCALE NTS
				WT. 
				SHEET 1 OF 1

DATE: 07/01/06 FORM: DRAWING