

REVISIONS			
SYS	DESCRIPTION	DATE	APPROV
B	PER ECN 1168 & 1187	05/24/10	

LOGO STAMP OPTIONAL

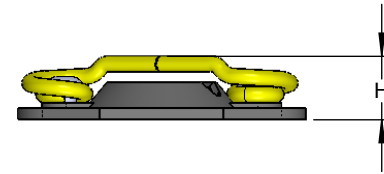
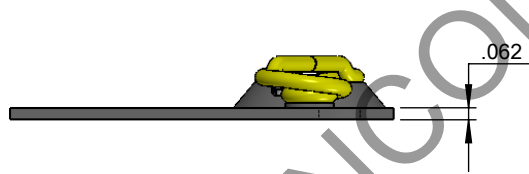
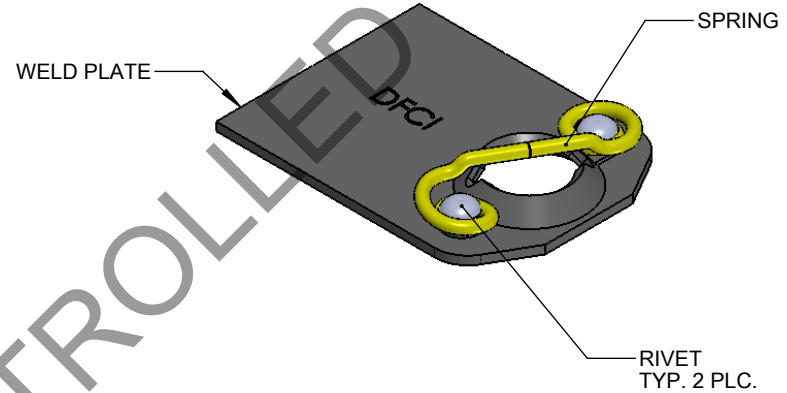
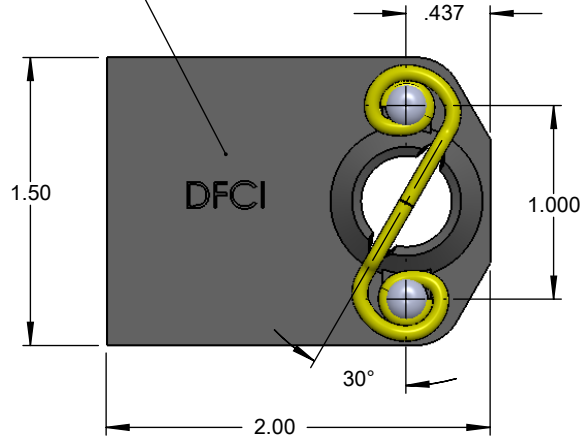

UNCONTROLLED

UNCONTROLLED

MATERIAL	PER NOTE 4
HEAT TREAT	NONE
FINIS H:	PER NOTE 3
<small>THE FASTENER PARTS SHOWN IN THIS PRINT ARE PROPRIETARY ARTICLES TO WHICH DFCI SOLUTIONS INC. RETAINS THE EXCLUSIVE RIGHTS OF MANUFACTURE, USE AND SALE. THE PRINT OR DRAWING IS SUBMITTED IN CONFIDENCE AND DOES NOT CONVEY A LICENSE OR PERMISSION TO MANUFACTURE THE FASTENER OR FASTENER PARTS.</small>	
<small>(C) COPYRIGHT 2009, DFCI SOLUTIONS INC. ALL RIGHTS RESERVED.</small>	

TOLERANCES ON DIMENSIONS UNLESS OTHERWISE SPECIFIED			
X* = ±2°	.XX = ±.015	MACHINE FINISH = .125	
X/X = ±1/32	.XXX = ±.010		
PART NO.	DRN	DATE	
	F. Basile	05/24/10	
	CHK. <i>Frank Basile</i>	DATE	09/23/10
	ENG. <i>Bob Altkorn</i>	DATE	09/23/10
	MFG. <i>Bill Velazquez</i>	DATE	09/23/10
NEXT ASSY	USED ON	Q.C. <i>Bob Altkorn</i>	DATE
		09/23/10	
APPLICATION BLOCK	SALES.	DATE	



DFCI SOLUTIONS INC.
 425 UNION BOULEVARD.
 WEST ISLIP, NEW YORK 11795

TITLE				ST-1200 WELD PLATE. RECEPTACLE	
				1224-945-xxx	
SIZE	FSCM NO	DWG. NO.	C1224-945	REV	B
A	72794				
SCALE: NTS			WEIGHT:		SHEET 1 OF 2

